

SUMMARY & EXPLANATION

Infectious mononucleosis (IM) is an acute, self-limited, lymphoproliferative disease caused by the Epstein-Barr virus (EBV). Infection with EBV usually occurs early in life with no recognizable disease. When primary infection is delayed until young adulthood and adolescence, however, there is about a 50% chance that it will occur with the classic clinical manifestations associated with IM.<sup>1,2</sup> The diagnosis of IM is usually based on the evaluation of characteristic clinical, hematological, and serological changes. In most cases of IM, clinical diagnosis can be made from the characteristic triad of fever, pharyngitis, and cervical lymphadenopathy, lasting for 1 to 4 weeks. IM may be complicated by splenomegaly, hepatitis, pericarditis, or central nervous system involvement.<sup>3</sup> Rare fatal primary infections occur in patients with histiocytic hemophagocytic syndrome<sup>4</sup> or with a genetic X-linked lymphoproliferative syndrome.<sup>5</sup> Hematologic features of IM include lymphocytosis with prominent atypical lymphocytes. Because other diseases may mimic the clinical and hematological symptoms of IM, serological testing is essential for the most accurate diagnosis. Serological diagnosis of IM is demonstrated by the presence of heterophile and EBV antibodies in the sera of patients.<sup>2,6,7</sup>

It has been well established that most individuals exposed to EBV develop a heterophile antibody response. Heterophile antibodies make up a broad class of antibodies which are characterized by the ability to react with surface antigens present on erythrocytes of different mammalian species. It is not known which specific antigen stimulates their production. It has been a common practice for physicians to use the detection of IM heterophile antibodies in the blood of patients as an aid in the diagnosis of IM. This test utilizes an extract of bovine erythrocytes which gives a greater sensitivity and specificity than similar extracts prepared from sheep and horse erythrocytes. The Forssman<sup>8,9</sup> antibody interference has been known to be minimized by using the bovine erythrocyte extract.

PRINCIPLE OF THE TEST

AimStep® Mono one-step antibody test for IM uses direct solid-phase immunoassay technology for the qualitative detection of IM heterophile antibodies in human serum, plasma or whole blood. In the test procedure, 10 µl serum or plasma are added in the Sample Well (S) located below the result window. For finger-tip or whole blood, 25 µl of blood is collected in a sample transfer pipette and spotted in the Sample Well (S). If any IM-specific heterophile antibody is present in the sample, it will be captured by the antigen band (bovine erythrocyte extracts) impregnated in the test membrane. The developer solution is then added in Sample Well (S). As the specimen followed by the developer moves by capillary action to the antigen band, the solution mobilizes the dye conjugated to anti-human IgM antibodies. Visualization of the antigen band at the Test position (T) in the result window will occur only when the IM-specic heterophile antibody binds to the extracted antigen obtained from bovine erythrocytes. As the antibody-dye conjugate continues to move along the test membrane, it will bind to another band located at the Control position (C) to generate a colored band regardless of the presence of IM heterophile antibodies in the sample. Therefore, the presence of two colored bands, one at the Test position (T) and the other at the Control position (C), indicates a positive result, while the absence of a colored band at the Test position (T) indicates a negative result.

REAGENTS AND MATERIALS

Materials Provided

- 1. Test Device (contains a membrane strip coated with bovine erythrocyte extract and a pad impregnated with the monoclonal mouse anti-human IgM antibody-dye conjugate in a protein matrix containing 0.1% sodium azide.
- 2. Developer Solution: Phosphate saline buffer containing 0.1% sodium azide as preservative.
- 3. Negative Control: Diluted in serum containing 0.1% sodium azide as preservative.
- 4. Positive Control: Diluted in serum containing 0.1% sodium azide as preservative.
- 5. (10 µL) (black line) sample transfer pipettes for use with serum/plasma.
- 6. (25 µL) (red line) sample transfer pipettes for use with whole blood.
- 7. Package Insert
- 8. Procedure Card

Materials Requires but Not Provided

- 1. Centrifuge capable of separation of blood cells from plasma
- 2. Lancet
- 3. Timer

STORAGE AND STABILITY

AimStep® Mono test kit should be stored at 2°- 30°C (36°- 86°F) in its sealed pouch. Do not freeze. The storage conditions and stability dating given were established under these conditions.

PRECAUTIONS

- 1. The reagents in this kit contain sodium azide. Sodium azide may react with lead and copper plumbing to form highly explosive metal azides. Upon disposal, flush with a large amount of water to prevent azide buildup.
- 2. All patient samples should be handled as if they are capable of transmitting disease. Observe established precautions against microbiological hazards throughout all procedures and follow the standard procedures for proper disposal of potentially infectious specimens.
- 3. Human blood and its products are potentially infectious; handle with appropriate precautions.
- 4. For in vitro diagnostic use. Do not use after expiration date.
- 5. Do not interchange reagents from different kit lots or use beyond the expiration date. The reagent in each kit are tested by Quality Control to function as a unit to assure proper sensitivity and maximum accuracy.
- 6. Use AimStep® Mono test only in accordance with instructions supplied with the kit.

SPECIMEN COLLECTION & PREPARATION

Whole Blood:

- 1. Anticoagulated Blood: Whole blood collected over CPDA-1, heparin or EDTA can be used. Mix whole blood by inversion and use in the test as outlined in the Test Procedure. Whole blood can be stored at 2°- 8°C for 24 hours. If testing is anticipated after 24 hours, separate plasma, as outlined below, and freeze at or below -20°C.  
Caution: Do not freeze & thaw whole blood; hemolyzed blood cannot be used in this test.
- 2. For fingertip blood, prick the finger and discard the first drop. Wipe the finger and use a micropipette to collect 25µl of blood from the second drop. Immediately transfer the blood on to the upper end of the Sample Well (S) of the test device as outlined in the "Test Procedure".

Serum or Plasma:

Use serum or plasma obtained from blood collected aseptically by venipuncture into a clean tube. If serum or plasma filter isolates are used, follow the manufacturer's instructions. For serum, no anticoagulant should be used. For plasma, collect the whole blood specimen into a tube containing anticoagulant such as CPDA-1, heparin, or EDTA. For serum, blood should be allowed to clot at room temperature (18°- 24°C) and then centrifuged at 1500 x g for ten minutes at room temperature. The serum should be separated as soon as possible and may be tested immediately. Remove the serum or plasma from the clot or red cells as soon as possible to avoid hemolysis. When possible, clear, nonhemolyzed specimens should be used. Mildly hemolyzed specimens do not affect the test result, but may create an undesirable reddish background in the result window. Specimens containing any particulate matter may give inconsistent test results. Such specimens should be clarified by centrifugation prior to testing. Collect the serum or plasma in the sample transfer pipette up to the black fill line (10µL). Follow the test procedure.

Storage of specimens

Refrigerate all specimens at 2°- 8°C until ready for testing. If serum or plasma specimens will not be tested within 48 hours of collection, they should be stored at or below -20°C. Specimens should not be repeatedly frozen and thawed. If specimens are to be mailed, they should be packed in appropriate shipping containers as currently described by the carrier for handling of potentially infectious materials.

QUALITY CONTROL

A quality control check is recommended using commercially available control sera. There are two internal control features in AimStep® Mono test. A colored control band will always appear at the Control position (C) if the test has been performed correctly and if the device is working properly. This is considered an internal positive procedural control. A clear background in the result window is considered an internal negative procedural control. If the test has been performed correctly and AimStep® Mono device is working properly, the background in the result window will be clear, providing a distinct result.

Good laboratory practice recommends the periodic use of external control materials to ensure proper kit performance. The included positive and negative controls can be run in place of serum or plasma according to the test procedure for this purpose.

Use the 10µL (black fill line) transfer pipette when testing external controls and serum/plasma proficiency survey samples.

If the controls do not perform as expected or the colored control band does not appear at the Control position (C) contact Technical Services immediately for assistance at 800-854-8446.

Procedural Notes

- 1. The test protocol must be followed in order to achieve optimal test reactivity with specimens. Follow the assay procedure and always perform the test under carefully controlled conditions.
- 2. Allow AimStep® Mono test devices, reagents and specimens to warm to room temperature before testing.
- 3. AimStep® Mono test device should remain in the sealed pouch prior to testing.
- 4. Do not reuse a lancet.
- 5. To avoid cross-contamination, use a new disposable sample transfer pipette for each specimen.
- 6. Label the device with the patient's name or control number.
- 7. When collecting finger-tip blood, allow a free flow drop to form. Wipe away the first drop and collect the second drop. Do not squeeze the finger too hard. Follow instructions under "Specimen Collection and Preparation."
- 8. To add the Developer Solution, hold the dropper bottle in a vertical position above the LOWER END of the Sample Well (S) and dispense 2-3 drops in the well.
- 9. Mildly hemolyzed whole blood specimens do not affect the test result, but may create an undesirable reddish background in the result window.
- 10. To avoid contamination, do not touch the tip of the Developer Solution dropper bottle to skin or AimStep® Mono test device.
- 11. Use accepted microbiological practices for proper disposal of potentially infectious test materials and disinfection of contaminated equipment.
- 12. After testing, dispose of AimStep® Mono test devices, sample transfer pipettes and specimens in approved biohazard containers.

Directions For Use Of Sample Transfer Pipette

The sample transfer pipette has an air vent positioned on the sidewall of the pipette to provide automatic air venting & sample volume control. NOTE: Once the specimen is drawn into the sample transfer pipette, the pipette will not leak; the pipette will hold the specimen until the bulb of the pipette is squeezed.

CAUTION: Filling is automatic: Do not squeeze the sample transfer pipette while filling. Avoid air bubbles.

**Step 1:** Hold the sample transfer pipette horizontally and touch the tip of the pipette to the sample. DO NOT SQUEEZE the pipette. The specimen can be obtained from vacutainer, test tube or fingerstick. Capillary action will automatically draw up the correct volume to the fill line and stop.

**Step 2:** To expel sample, align the tip of the pipette over the Sample Well (S) of the test device. SLOWLY squeeze the bulb until a hanging drop forms & touch this drop to the sample pad.

NOTE: If a sample does not expel, hold the pipette vertically and place a finger over the vent hole. Then align the pipette tip over the Sample Well (S) of the test device and SLOWLY squeeze the bulb until a hanging drop forms and touch this drop to the sample pad.

TEST PROCEDURE

**Step 1:** Remove a device from pouch and place on flat surface.

**Step 2:** Collect the sample using the appropriate sample transfer pipette according to the volume of sample required. Use the 25µL (red line) sample transfer pipette for whole blood or the 10µL (black line) sample transfer pipette for serum/plasma samples. Apply sample on the pad of the UPPER AREA of the Sample Well (S).

**Step 3:** Add 2-3 drops of Developer Solution onto the LOWER AREA of the Sample Well (S).

**Step 4:** Read the results at 8 minutes. Do not read test after 15 minutes.

INTERPRETATION OF RESULTS

**Positive:** One pink-purple colored horizontal band each at the Test Position (T) and at the Control Position (C) indicates that IM-specific heterophile antibodies have been detected.

Note: A positive test result may be read as soon as a distinct pink-purple colored band appears at the Test position (T) and at the Control position (C) Any shade of pink-purple colored horizontal band at the Test position (T) should be reported as a positive result. The intensity of the colored band at the Test position (T) may be different from the intensity of the band at the Control position (C).

**Negative:** One pink-purple colored horizontal band at the Control position (C) with no distinct colored horizontal band at the test position (T) other than the normal faint background color, indicates the IM-specific heterophile antibodies have not been detected.

**Invalid:** A distinct colored horizontal band at the Control position (C) should always appear. The test is invalid if no such band forms at the Control position (C). AimStep® Mono test is optimized to have a minimal prozone effect. Therefore, specimens containing a very high titer of antibody may produce a somewhat weaker signal but would still produce a positive result. The test does not require any specimen dilution, but it is recommended that the specimen be diluted and retested to confirm the result in case a prozone effect is suspected. The test should be used only for the qualitative detection of heterophile antibody.

Air vent regulates volume

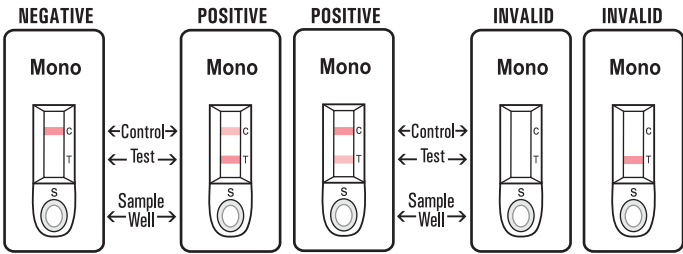
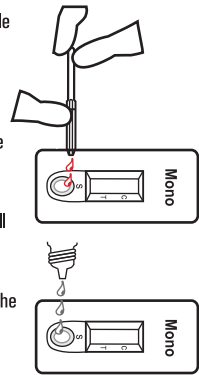
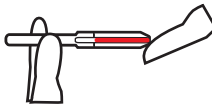
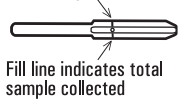

LIMITATIONS

- 1. The results obtained by this kit yield data which must be used only as adjunct to other information available to the physician.
- 2. Although most patients will have a detectable heterophile antibody level within three weeks of infection, occasionally a patient with strong clinical signs of IM may take longer than three months to develop a detectable level.<sup>1</sup> If further testing is desired, collect additional specimens every few days and retest.
- 3. Some segments of the population who contract IM do not produce measurable levels of heterophile antibody. Approximately 50% of children under 4 years of age who have IM may test as IM heterophile antibody negative.<sup>1</sup> EBV-specic laboratory diagnosis may be helpful in these cases.
- 4. Some individuals are reported to maintain a low but persistent level of heterophile antibodies long after their primary illness. Heterophile antibodies have been detected in blood specimens taken more than one year after the onset of the illness.<sup>4</sup> Such false positive test results occurring in 2-3% of patients can be excluded by EBV-specic serology.<sup>5</sup>
- 5. The IM heterophile antibody has been associated with disease states other than IM, such as leukemia, cytomegalovirus, Burkitt's lymphoma, rheumatoid arthritis, adenovirus, viral hepatitis, and Toxoplasma gondii.<sup>13</sup> In primary infections of adults with clinically atypical diseases, EBV-specific laboratory diagnosis may also be helpful.
- 6. AimStep® Mono for serum and plasma is classified as moderately complex under the CLIA '88 regulations. AimStep® Mono for whole blood test is classified as waived under the CLIA '88 regulations.
- 7. Open or broken/damaged pouches may produce erroneous results due to kit instability from exposure to moisture and should be discarded - Do Not Use.

EXPECTED VALUES

- 1. In patients with symptoms indicating IM, a positive heterophile antibody result is diagnostic, and no further testing is necessary. During the acute phase of illness, IM-specific heterophile antibodies are detectable in 80-85% of IM cases. Humoral responses to primary infections appear to be quite rapid. Moderate to high levels of heterophile antibodies are seen during the first month of illness and decrease rapidly after week four.<sup>9</sup>
- 2. Positive test results may persist for months or even years due to the presence of persistent IM heterophile antibodies.<sup>12, 15-17</sup> This may occur with or without any clinical symptoms or hematological evidence of IM.<sup>18, 19</sup> Conversely, a confirmed heterophile antibody test may indicate an occult infection.<sup>18, 19</sup> In fact, detection of IM prior to onset of clinical symptoms has been reported.<sup>20, 21</sup>
- 3. Some patients remain persistently negative, even though there may exist hematological and clinical evidence of IM.<sup>13, 22</sup> In some of these patients, serological evidence for a diagnosis of CMV infection, toxoplasmosis, or viral hepatitis, as well as others, have been found.<sup>13, 23</sup>

PERFORMANCE CHARACTERISTICS

Specificity

The following potentially interfering substances do not interfere with infectious mononucleosis heterophile antibody determinations in AimStep® Mono assay up to the levels shown below:

Human Albumin	15 g/dL	Hemoglobin	1 g/dL
Bilirubin	60 mg/dL	Triglycerides	1,300 mg/dL

Proficiency Testing Results

Venous blood was taken from 20 individuals. Five samples out of twenty were spiked with mononucleosis positive serum. Plasma was separated from these samples to test with AimStep® Mono Kit. These spiked and unspiked samples were provided to a clinical POL site for blind testing. The results showed 100% correlation.

Clinical Testing Results

A total of 432 whole blood clinical samples (152 finger-stick & 280 venous blood) were tested at 7 different Physician Office Laboratory (POL) clinical sites, a reference laboratory, and in-house. Concurrently, serum or plasma samples from the same patients were obtained and tested at the same sites. In addition, a total of 144 serum/plasma samples were tested at a reference laboratory clinical site (Table 1).

Table 1 Clinical Sample Testing Arrangement

Site	Finger Stick Blood	Venous Whole Blood	Serum/Plasma	Total
POL No. 1	0	50	0	50
POL No. 2	0	50	0	50
POL No. 3	6	42	0	48
POL No. 4	20	13	0	33
POL No. 5	31	31	0	62
POL No. 6	51	0	0	51
POL No. 7	17	17	0	34
Reference Lab	0	50	144	194
In-house	27	27	0	54
Total	152	280	144	576

Venous whole blood samples were tested with AimStep® Mono, and the corresponding serum/plasma samples were tested with a commercially available immunochromatographic heterophile antibody assay (Predicate) kit. When a finger stick blood sample was tested with AimStep® Mono, venous whole blood was drawn from the same patient at the same time. The plasma or serum was prepared from each venous whole blood sample and run on a AimStep® Mono device. AimStep® Mono results were compared with the commercially available immunochromatographic heterophile antibody assay (Predicate) test results (Table 3). In the case of serum/plasma samples, each sample was run on both AimStep® Mono and the commercially available immunochromatographic heterophile antibody devices, and the results were compared (Table 4). Table 2 combines both results shown in Tables 3 and 4. Table 2 shows that the agreement between two tests was 99.0% (570/576). AimStep® Mono demonstrated a relative specicity of 98.8% (479/485) and a relative sensitivity of > 99.9% (91/91). The results obtained with the AimStep® Mono test correlated well to the results obtained with the commercially available immunochromatographic heterophile antibody assay test.

Table 2: Total Specimens

	AimStep® Mono		Total
	Positive	Negative	
Comercially available immunochromatographic	Positive 91	0	91
heterophile antibody assay	Negative 6	479	485
	Total 97	479	576

Table 3: Whole Blood (Finger Stick and Venous)

	AimStep® Mono		Total
	Positive	Negative	
Comercially available immunochromatographic	Positive 77	0	77
heterophile antibody assay	Negative 6	349	355
	Total 83	349	432

Table 4: Serum or Plasma Specimens

	AimStep® Mono		Total
	Positive	Negative	
Comercially available immunochromatographic	Positive 14	0	14
heterophile antibody assay	Negative 0	130	130
	Total 14	130	144

REFERENCES

1. Davidson I. Serologic Testing of Infectious Mononucleosis. J. Am. Med. Assoc. 108:289, 1937

2. Evans, A.S. History of Infectious Mononucleosis. Am J Med Sci 267:189, 1974.

3. Lennette, E.T. Epstein-Barr Virus. Manual of Clinical Microbiology, 5th ed., Balows, A., et al (ed.) American Society for Microbiology, Washington DC, pp. 847-852, 1991.

4. Grierson, H. and Purtillo, D.T. Epstein-Barr Virus infect. in Males with X-linked LD Syndrome. Ann Intern Med 106:538, 1987.

5. Wilson, E.R., et al. Fetal Epstein-Barr Associated Hemophagocystic Syndrome J Pediatr 98:260, 1981.

6. Paul J.R. and Bunnell, W.W. The Presence of Heterophile Antibodies in Infectious Mononucleosis. Am J. Med Sci 183:91, 1932.

7. Lennette, E. and Henle, W. Epstein-Barr Virus Infections: Clinical and Serological features. Lab Manager 25:23, 1987.

8. Baily, G.H. and Ra-el, S. Hemolytic Antibodies for Sheep and Ox Erythrocytes Infect. Mono. J. Clin Invest 14:228, 1935.

9. Fletcher, M.A. and Woodfolk, B.J. Immunological Studies of Infectious Mononucleosis: Isolation and Characterization of Heterophile Antigens from Hemoglobin-free Stroma. J. Immunol 107:842, 1971.

10. Penman, H.G. Seronegative Glandular Fever. J. Clin Path 21:50, 1968.

11. Fleisher, G.R. Textbook of Human Virology, Belshe, R.B. (ed) Littleton, Mass., PSG Publishing Co., pp 853-886, 1984.

12. Evans, A.S., et al. A prospective Evaluation of Heterophile and Epstein-Barr Virus-Specific IgM Antibody tests in Clinical and Subclinical Infectious Mono.: Specicity and Sensitivity of Tests and Persistence of Antibody. J Infect Dis 132:546, 1975.

13. Chin, T.D.Y. Diagnostic Criteria and Differential Diagnosis: Infectious Mononucleosis, 2nd ed. Schlossberg, D. (ed) Sprifinger-Verlag, New York, 1990.

14. Henle, W.G., et al. Infectious Mononucleosis and Epstein-Barr Virus Associated Malignancies: Diagnostic Procedures for Viral, Rickettsial and Chlamydial Infections, 5th ed. Lennette, E. H. and Schmidt, N.J. (ed) American Public Health Association, Inc., Washington D.C. 1979.

15. Henle, G., et al. Relation of Burkitt's Tumor Associated Herpes-type Virus to Infectious Mononucleosis. Proc Natl Acad Sci U.S.A. 59:94, 1968.

16. Askinazi, C., et al. Positive Differential Heterophile Antibody Test. Persistence in a Symptomatic Patient. J Am Med. assoc 236:1492, 1976.

17. Horwitz, C.A., et al. The Specicity of Heterophile Antibodies in Patients and Healthy Donors with No or Minimal Signs of Infectious Mononucleosis. Blood 47:91, 1976.

18. Hallae, T.J., et al. Infectious Mononucleosis at the United States Military Academy: A Prospective Study of a Single Class Over Four Years. Yale J Biol Med 3:182, 1974.

19. Infectious Mononucleosis and Its Relationship to EB Virus Antibody. A Joint Investigation by University Health Physicians and P.H.L.S. Laboratories. Br. Med J 11:643, 1971.

20. Bauer, S. and Holf, G. Test Detects Mononucleosis in Incubation Period. Annual Meeting of ASCP and CAP, Chicago, Illinois, October 15-23, 1965.

21. Baehner, R.J. and Schuler, S.E. Infectious Mononucleosis in Childhood. Clinical Expressions, Serologic Findings, Complications, Prognosis. Clin Pediatr 6:393, 1967.

22. Henle, G. and Henle, W. Epstein-Barr Virus and Infectious Mononucleosis. N Engl J Med 288:263, 1973.

23. Cameron, D. and McBean, L.M. A Clinical Study of Infectious Mononucleosis and Toxoplasmosis. Baltimore, The Williams and Wilkins Company, pp. 24-27, 1973.

#63-77025, Revised 02-19

# AimStep® Mono

Immunoassay for the Qualitative Detection of Infectious Mononucleosis Heterophile Antibodies in Whole Blood, Serum or Plasma

## Serum/Plasma/Whole Blood For In-Vitro Diagnostic Use

INTENDED USE

AimStep® Mono test qualitatively detects infectious mononucleosis antibodies in human whole blood, serum or plasma specimens. This test is intended for use as an aid in the diagnosis of infectious mononucleosis.

## CLIA WAIVED For Whole Blood CLIA Moderately Complex for Serum and Plasma

2°C - 30°C Temperature Limitation: 2° to 30°C (36° to 86°F)

IVD In Vitro Diagnostic Medical Device

Do not reuse

Consult instructions

GERMAINE® LABORATORIES, INC.

San Antonio, Texas USA  
www.germainelabs.com  
8 0 0 . 8 5 4 . 8 4 4 6  
2 1 0 . 6 9 2 . 4 1 9 2  
2 1 0 . 6 9 2 . 4 1 9 8 fax

